



True Metrix Air Glucose Meter
Quick Start Guide



FOR THE COMPLETE USER GUIDE, GO TO

[HTTPS://WWW.REMOTECAREPARTNERS.COM/HOW-IT-WORKS/](https://www.remotecarepartners.com/how-it-works/)

Scroll to the bottom of the page and click the MORE button below the image of the meter

NOTES ON SAFETY

Please read this section carefully to familiarize yourself with the features and operations before using the unit.

- 1. Do not allow other people to use your blood glucose meter. The meter is specifically assigned to you and you only. Allowing other people to use your meter can mislead your provider.**
2. All parts of the kit are considered biohazardous and can potentially transmit infectious diseases, even after cleaning and disinfecting all parts.
3. Do not place the device in liquid or put it where it could fall into the liquid.
4. This device is only intended for the use described in this manual.
5. You can purchase your test strips through RCP or Over-the-counter at any store that sells the True Metrix Air strips.
6. Do not allow the device to contact surfaces that are too hot to touch.
7. Do not use the device where aerosol sprays are in use.
8. Do not use the device if it is not working correctly or if it is damaged.
9. Read the entire manual before using the product to test your blood glucose.
10. Operate the meter and test strips between 41-104 degrees F and 10-90% humidity

CAUTION: Your True Metrix Air meter works ONLY with True Metrix Air test strips and True Metrix Air control solution

QUICKSTART

Prepare: Wash your hands with soap and water. Dry thoroughly.

Gather supplies: Lancing device, lancet, tissue (for blotting blood from your finger after the puncture).

Prepare the lancing device: Remove a test strip from the vial and close the vial immediately.

Prepare the meter: With the meter off, Insert a test strip into the Test Port with the Contact End (black blocks) facing up. The meter turns on. **DO NOT** place the Test Strip in backward.

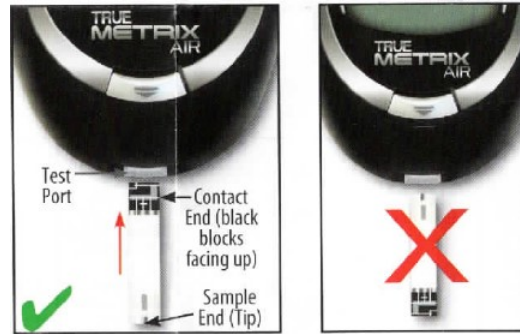

Perform the test: Place the lancet device on the finger you wish to use and press the release button. Place a drop of blood into the absorbent hole of the test strip. Use a tissue to absorb any extra blood from your finger. The reading will display in the LCD window within 5 seconds.

Transmit Your Reading: Once the reading displays in the LCD window, pull out the testing strip from the meter and throw it away. Press the Circle Button on the top of the device to transmit your reading to the SmartHub. The meter will shut off if you hold the button down after transmitting the reading.

Cleanup up: Pull Off the lancet device cap, eject the lancet into a sharps container or stab the lancet into the rounded end piece that was saved.

Understanding the Results

Reference value:

Time of day	People without diabetes
Before breakfast (fasting)	<100 mg/dL
Two hours after meals	<140 mg/dL

Source: American Diabetes Association. Standards of Medical Care in Diabetes-2012. Diabetes Care 2012,35 (Suppl.1) S11-S63. Please work with your provider to determine a target range that works best for you.